

NR LISTED 10/28/93

United States Department of the Interior
National Park Service

NATIONAL REGISTER OF HISTORIC PLACES
REGISTRATION FORM

1. Name of Property

historic name: Crossett Experimental Forest Bldg #8

other name/site number: AS 0086

2. Location

street & number: State Highway 133

not for publication: N/A

city/town: Crossett

vicinity: X

state: AR

county: Ashley

code: AR 003

zip code: 71635

3. Classification

Ownership of Property: Public-Federal

Category of Property: Building(s)

Number of Resources within Property:

Contributing	Noncontributing	
<u>1</u>	_____	buildings
_____	_____	sites
_____	_____	structures
_____	_____	objects
<u>1</u>	<u>0</u>	Total

Number of contributing resources previously listed in the National Register: N/A

Name of related multiple property listing: Facilities Constructed by the CCC in Arkansas, 1933-42

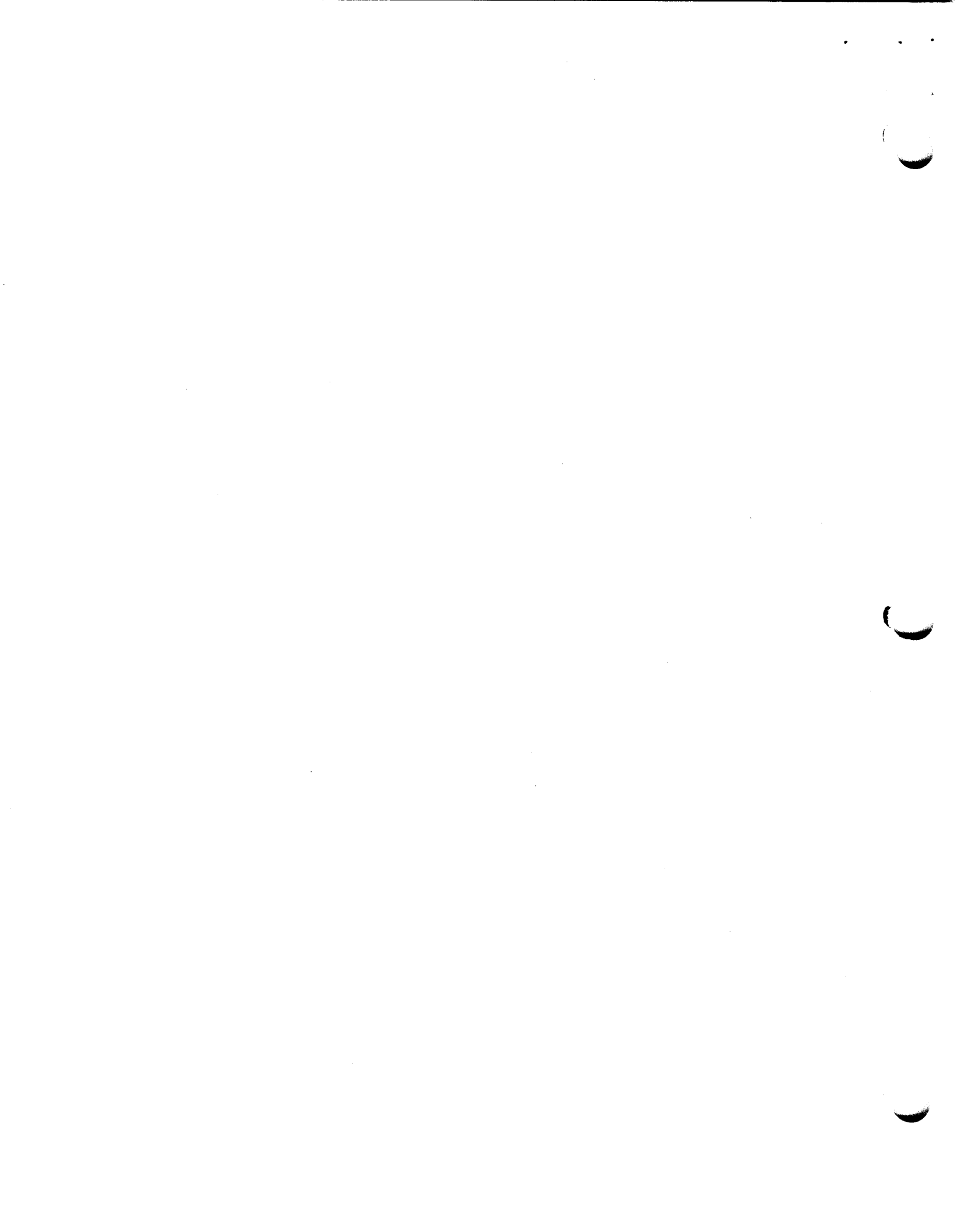

=====

4. State/Federal Agency Certification

=====

As the designated authority under the National Historic Preservation Act of 1986, as amended, I hereby certify that this _____ nomination _____ request for determination of eligibility meets the documentation standards for registering properties in the National Register of Historic Places and meets the procedural and professional requirements set forth in 36 CFR Part 60. In my opinion, the property _____ meets _____ does not meet the National Register Criteria. _____ See continuation sheet.

Signature of certifying official

Date

State or Federal agency and bureau

In my opinion, the property X meets _____ does not meet the National Register criteria. _____ See continuation sheet.

Signature of commenting or other official

Date

Arkansas Historic Preservation Program

State or Federal agency and bureau

=====

5. National Park Service Certification

=====

I, hereby certify that this property is:

____ entered in the National Register
_____ See continuation sheet.

____ determined eligible for the
National Register
_____ See continuation sheet.

____ determined not eligible for the
National Register

____ removed from the National Register

____ other (explain): _____

Signature of Keeper

Date
of Action

=====

6. Function or Use

=====

Historic: Government

Sub: Government Office

Current : Government

Sub: Government Office

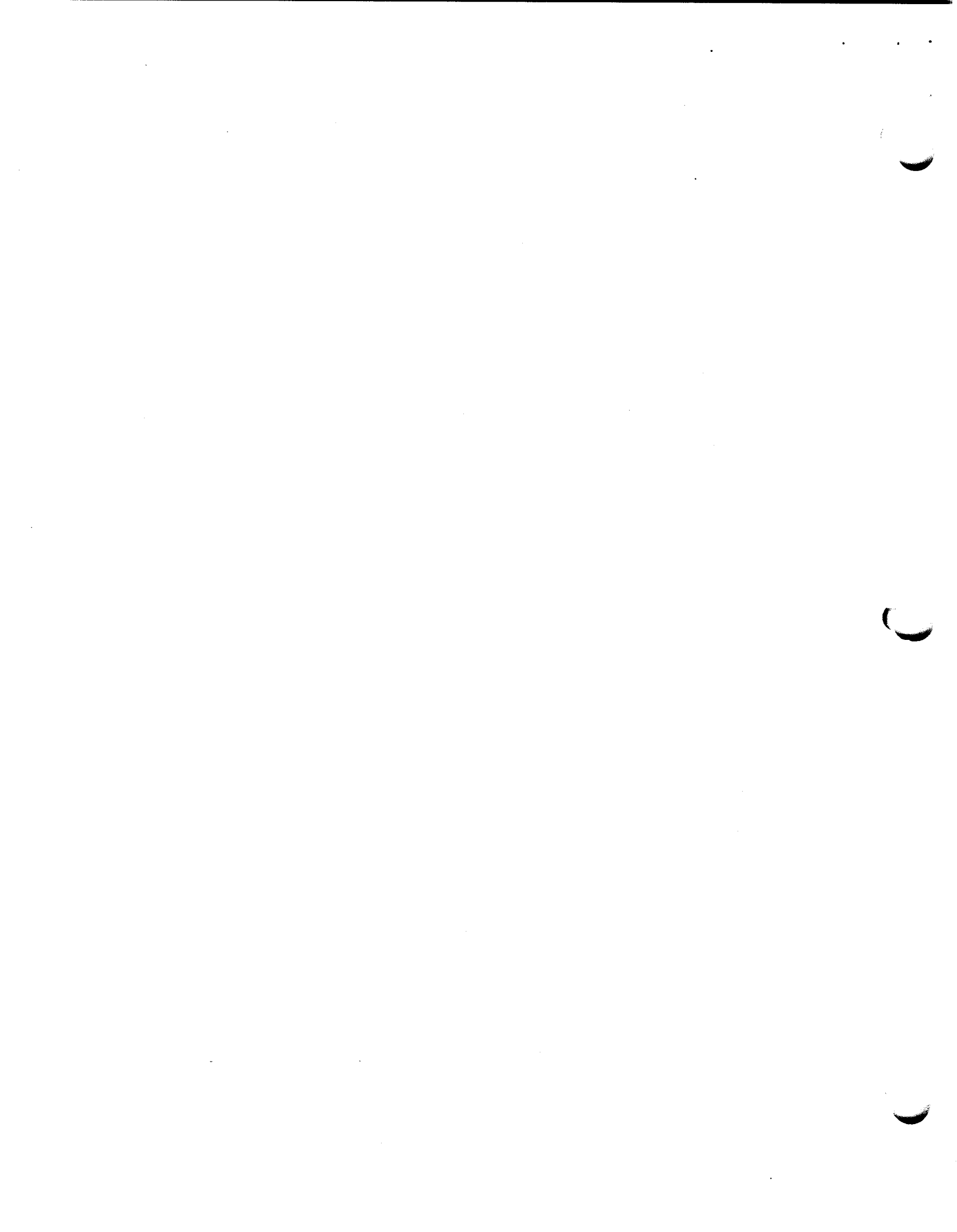

7. Description

Architectural Classification:

Other: Plain Traditional
Craftsman

Other Description: _____

Materials: foundation Concrete roof Asphalt
walls Wood/Weatherboard other _____

Describe present and historic physical appearance. X See continuation sheet.

8. Statement of Significance

Certifying official has considered the significance of this property in relation to other properties: locally.

Applicable National Register Criteria: A

Criteria Considerations (Exceptions) : N/A

Areas of Significance: Social History
Conservation

Period(s) of Significance: c.1940

Significant Dates : N/A

Significant Person(s): N/A

Cultural Affiliation: N/A

Architect/Builder: Civilian Conservation Corps

State significance of property, and justify criteria, criteria considerations, and areas and periods of significance noted above. X See continuation sheet.

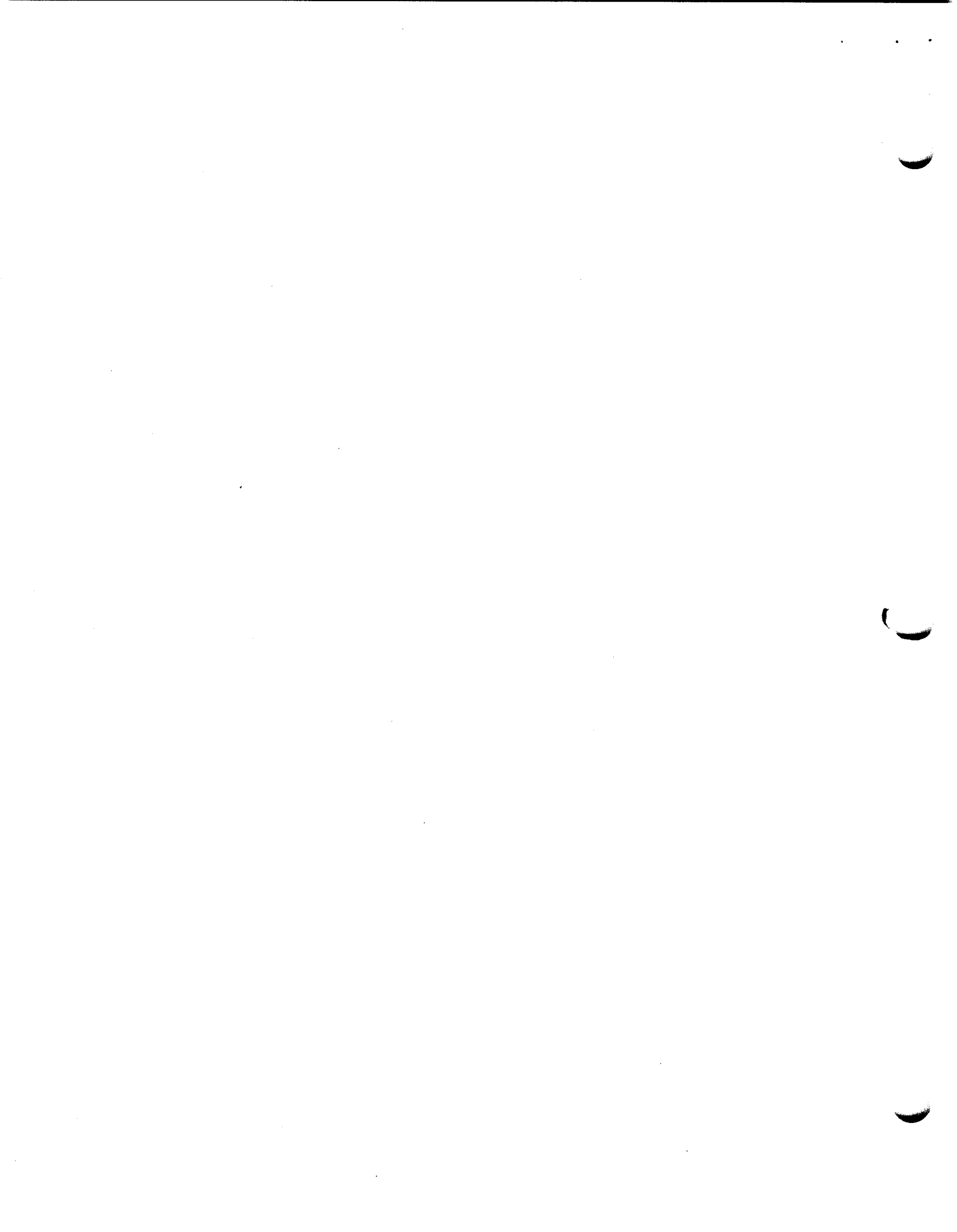

=====

9. Major Bibliographical References

=====

See "Facilities Constructed by the Civilian Conservation Corps in Arkansas, 1933-1942," Section H.

___ See continuation sheet.

Previous documentation on file (NPS):

- ___ preliminary determination of individual listing (36 CFR 67) has been requested.
- ___ previously listed in the National Register
- ___ previously determined eligible by the National Register
- ___ designated a National Historic Landmark
- ___ recorded by Historic American Buildings Survey # _____
- ___ recorded by Historic American Engineering Record # _____

Primary Location of Additional Data:

- ___ State historic preservation office
- ___ Other state agency
- ___ Federal agency
- ___ Local government
- ___ University
- ___ Other -- Specify Repository: _____

=====

10. Geographical Data

=====

Acreage of Property: Less than one

UTM References: Zone Easting Northing Zone Easting Northing

A	<u>15</u>	<u>599130</u>	<u>3655290</u>	B	___	___	___
C	___	___	___	D	___	___	___

___ See continuation sheet.

Verbal Boundary Description: ___ See continuation sheet.

Beginning at a point located 80 feet east of a point on the eastern edge of the associated driveway located 950 feet south of its intersection with State Highway 133, proceed easterly along a line running parallel with the building's northern elevation for a distance of 200 feet; thence proceed southerly along a line running parallel with the building's eastern elevation for a distance of 200 feet; thence proceed westerly along a line running parallel with the building's southern elevation for a distance of 200 feet; thence proceed northerly along a line running parallel with the building's western elevation for a distance of 200 feet to the point of beginning.

Boundary Justification: ___ See continuation sheet.

This boundary includes all the property historically associated with this resource, including the building itself, the associated driveway to the west, and all the surrounding property historically associated with this building that retains its integrity.

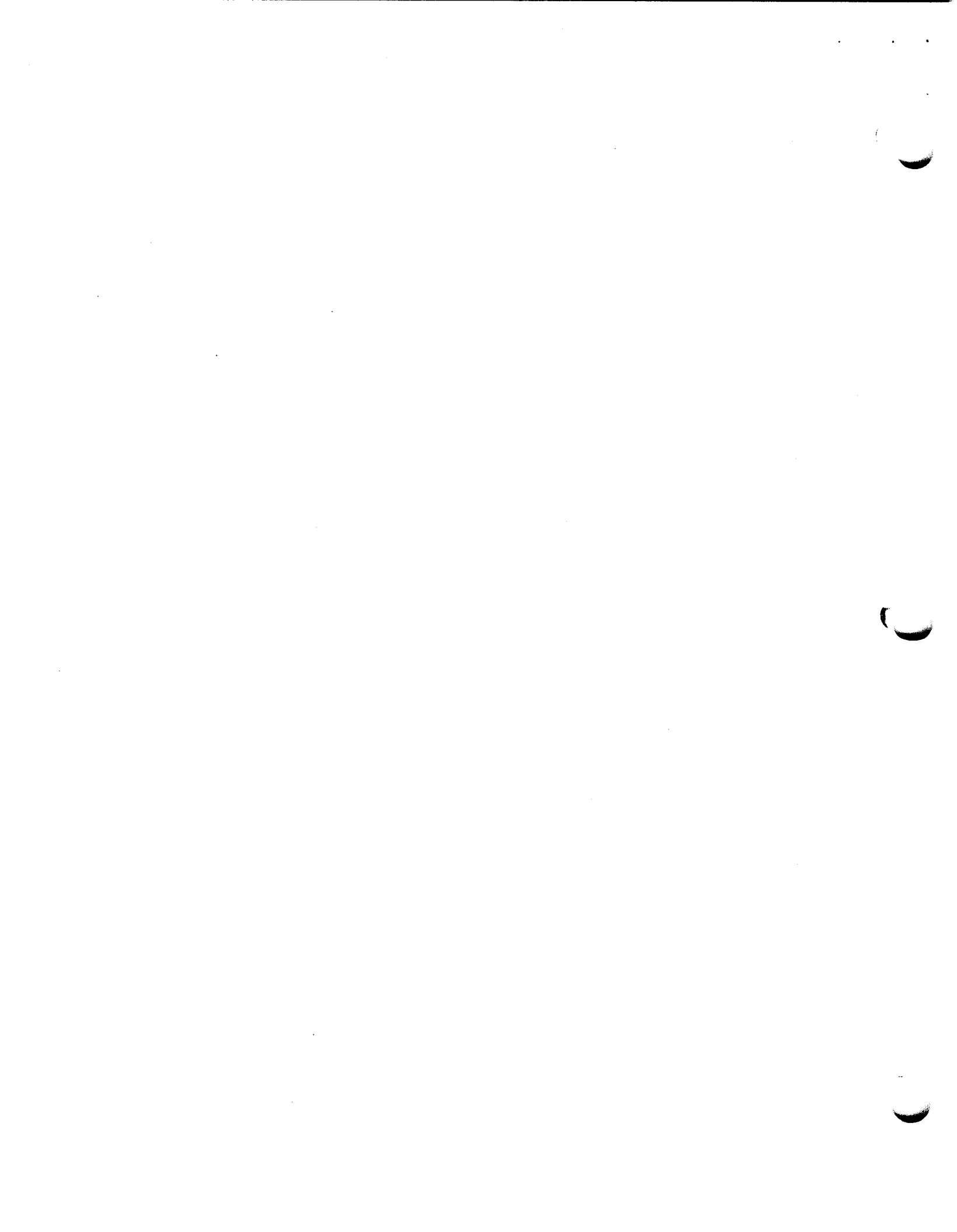

=====
Name/Title: Todd Ferguson, Historian/Ken Story, Architectural Historian

Organization: Arkansas Historic Preservation Program Date: 8/28/91

Street & Number: 225 E. Markham, Suite 300 Telephone: (501) 324-9346

City or Town: Little Rock State: AR ZIP: 72201

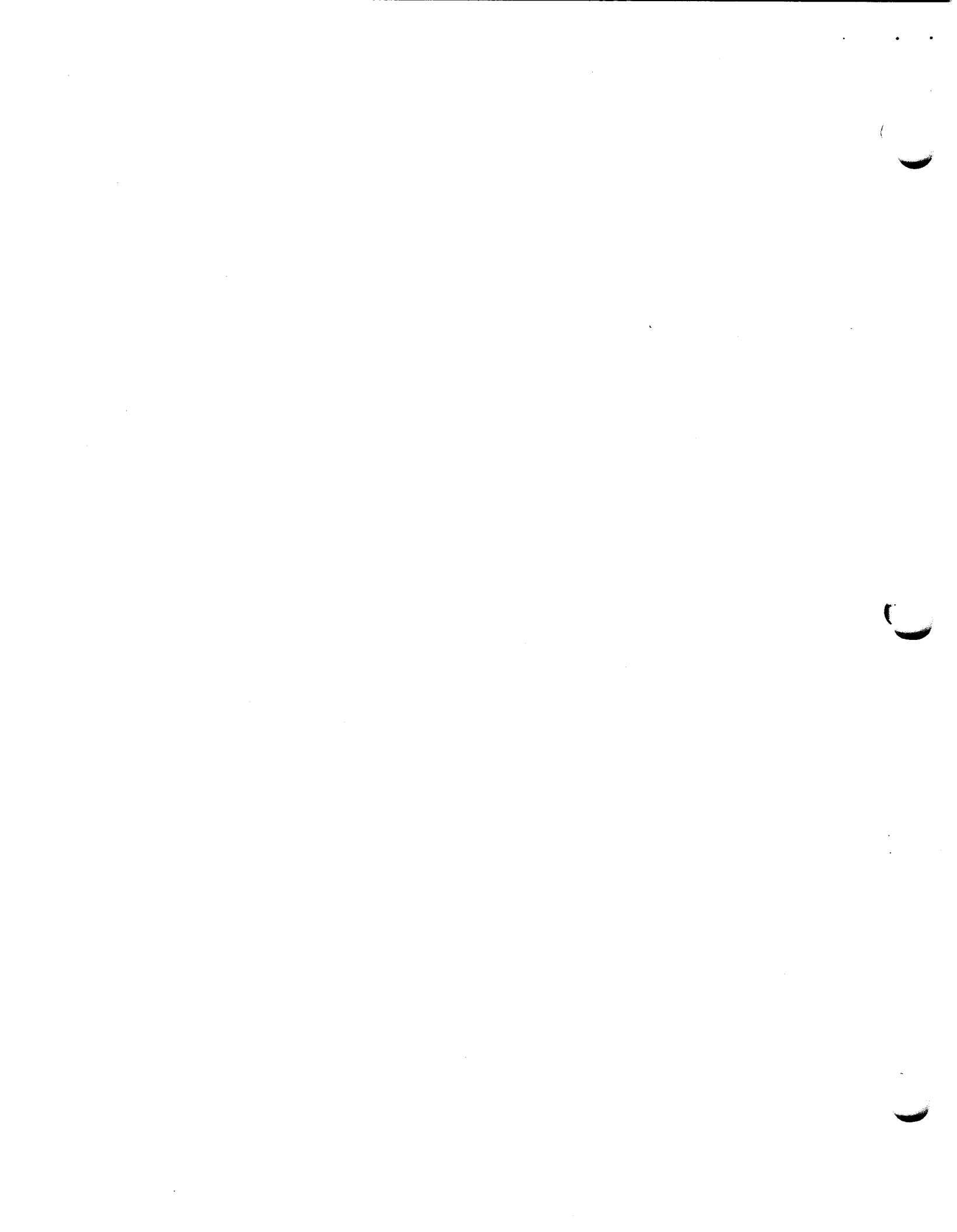

**United States Department of the Interior
National Park Service****National Register of Historic Places
Continuation Sheet**Section number 7 Page 1

Description:

The Crossett Experimental Forest Complex is located south of Crossett on Arkansas Highway 133 roughly one-and-one-half miles north of the Louisiana State line. Building No. 8 is a plain, frame structure with a rectangular plan and is one-and-one-half stories in height. The eastern elevation has a one bay, central front porch covered with a gabled roof which intersects with the gabled roof of the main structure. The eastern view also has four double-hung windows with a six-over-six pane arrangement and a small louvered vent in the pediment over the porch. The northern elevation has two six-over-six windows on the first floor and one six-over-six window on the second floor. Also along the northern view is a rear "L" which has a single door covered by a stoop. The western elevation features some diversity in the window arrangement: four different types of six-over-six windows including one double window in the center of the house. The rear "L" has a gabled roof which connects with the rear portion of the main roof line halfway up the gable and a few feet south of the northern elevation. The southern elevation is rather plain with two six-over-six windows on the first floor and one smaller six-over-six window on the second floor. The house has an interior chimney which is located at the intersection of the gables of the main roof line and the gable of the porch. The roof is covered with composition shingles and the walls are covered with novelty siding. The house is in good condition.

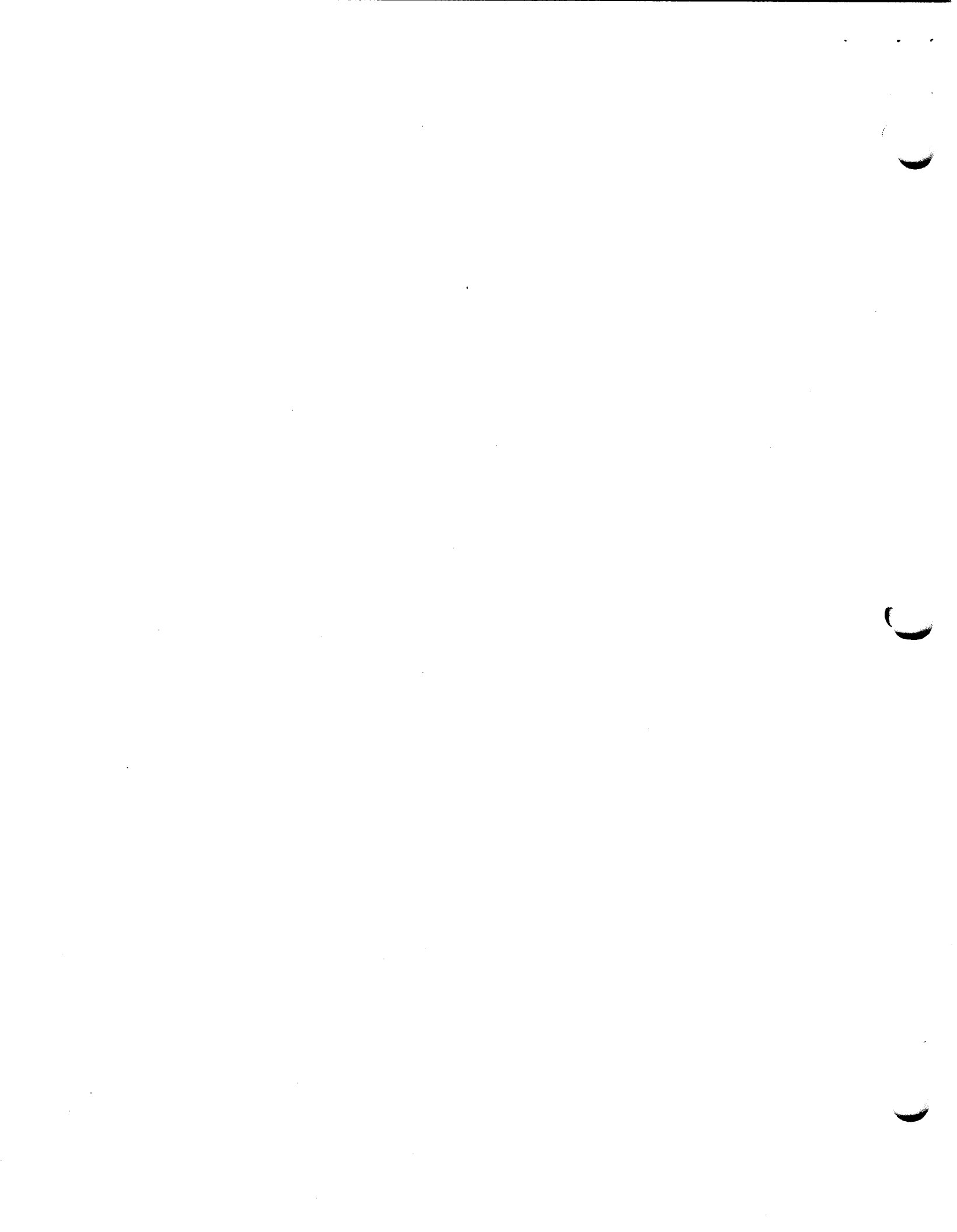

**United States Department of the Interior
National Park Service**

**National Register of Historic Places
Continuation Sheet**

Section number 8 Page 1

The Crossett Experimental Forest Building #8 was constructed circa 1940 by members of the 768th Company of the Arkansas CCC District stationed at the Oden Camp that was located at Oden, in northwestern Montgomery County, though it was later moved further northwest to Buck Knob. It was constructed as part of the administrative headquarters for the Southern Experimental Forest of the Ouachita National Forest (ONF). This building was one of the office buildings for the Experimental Forest, and it continues to serve that purpose today. As such, the Crossett Experimental Forest Building #8 remains significant through its associations with the significant contributions to American social history made by the Civilian Conservation Corps and for its associations with the conservation movement that President Roosevelt intended this organization to serve, particularly within such protected federal lands as the national forests.

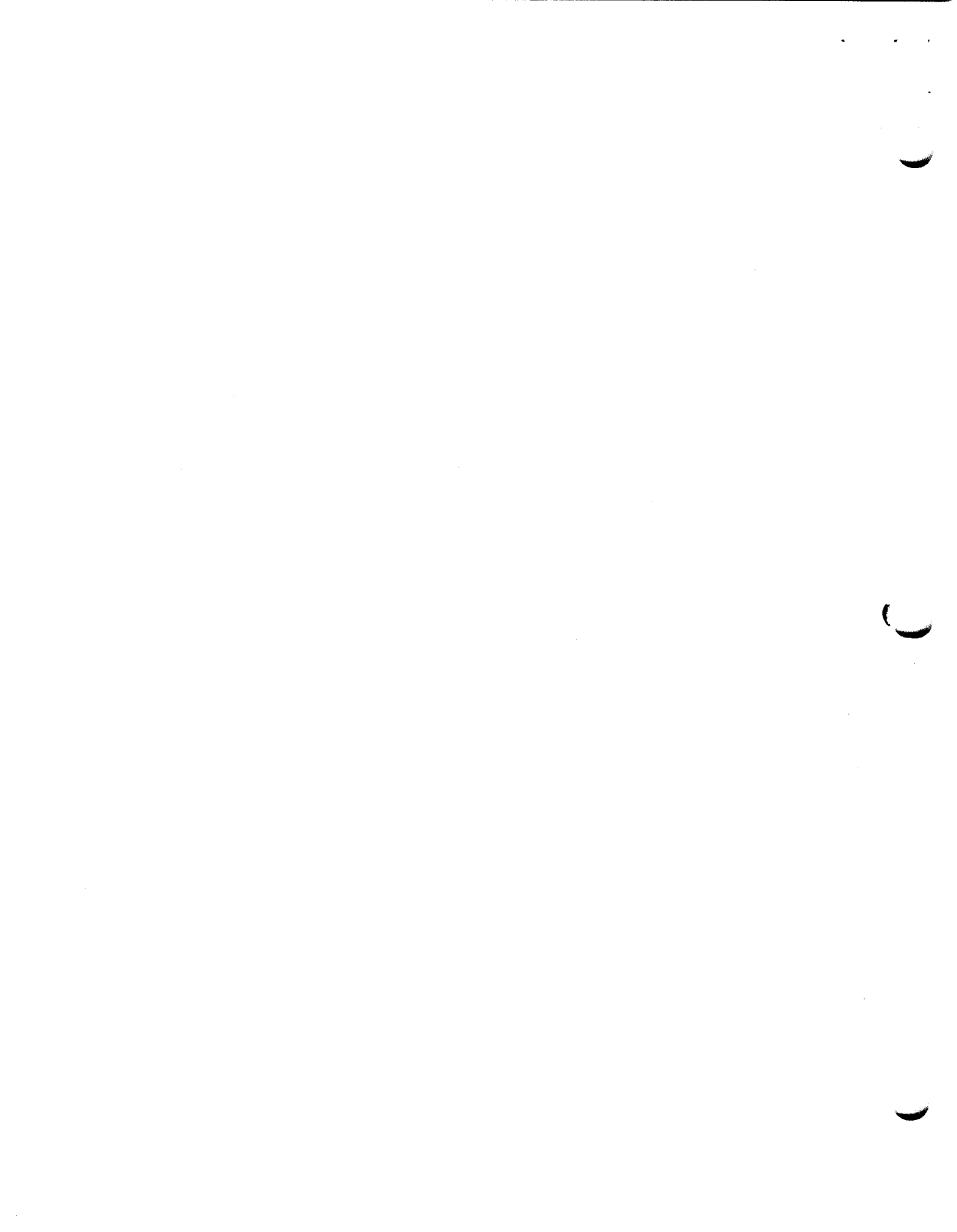



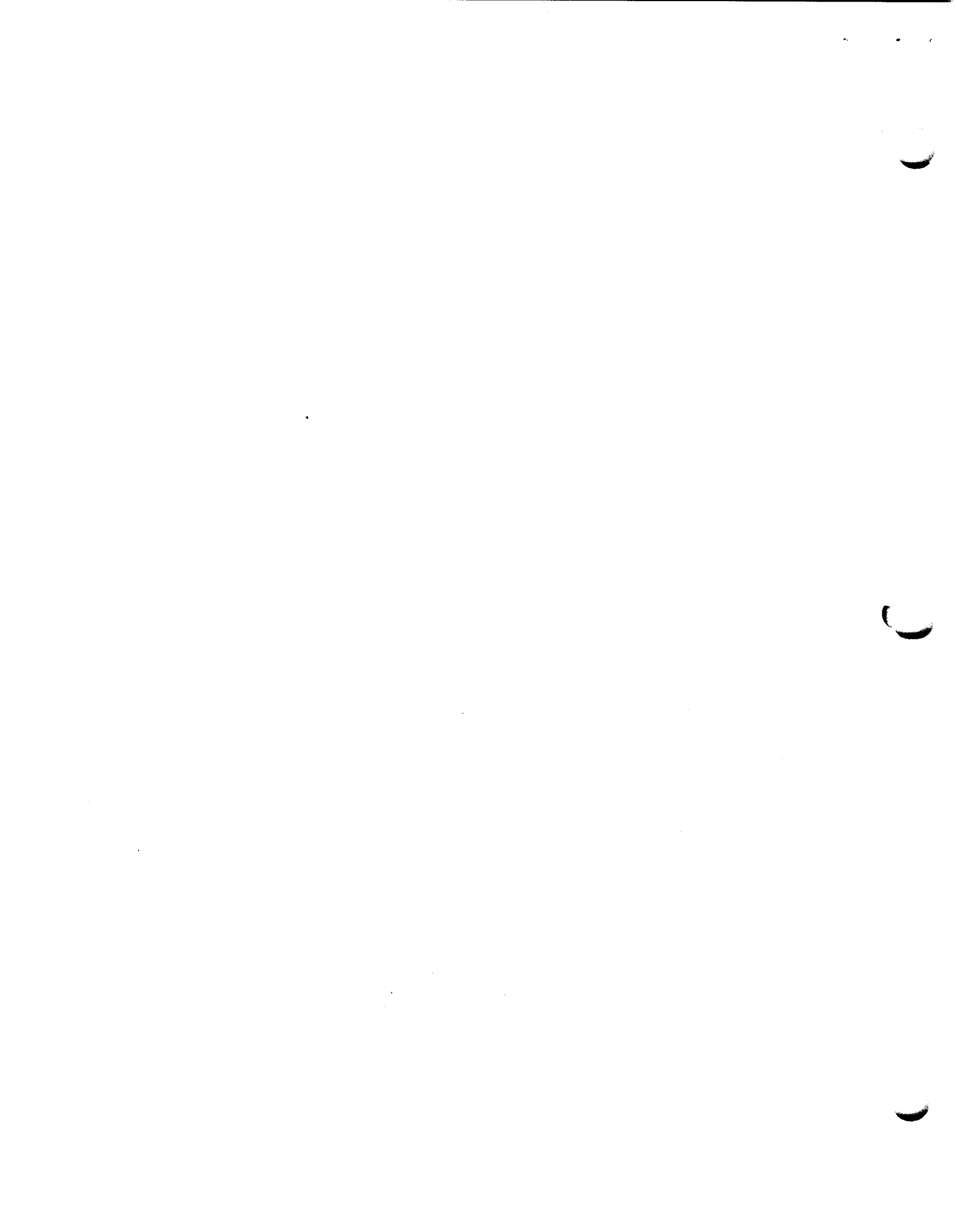

() pett Exp. Forest Bldg #2 (AS0080)
 .sett Exp. Forest Bldg #6 (AS0084)
 Crossett Exp. Forest Bldg #8 (AS0086)
 Crossett vic., Arkansas
 Ashley Co.
 AS0080: 15/599050/3655390
 AS0084: 15/599110/3655230
 AS0086: 15/599120/3655290
 Crossett South Quadrangle
 1:24000

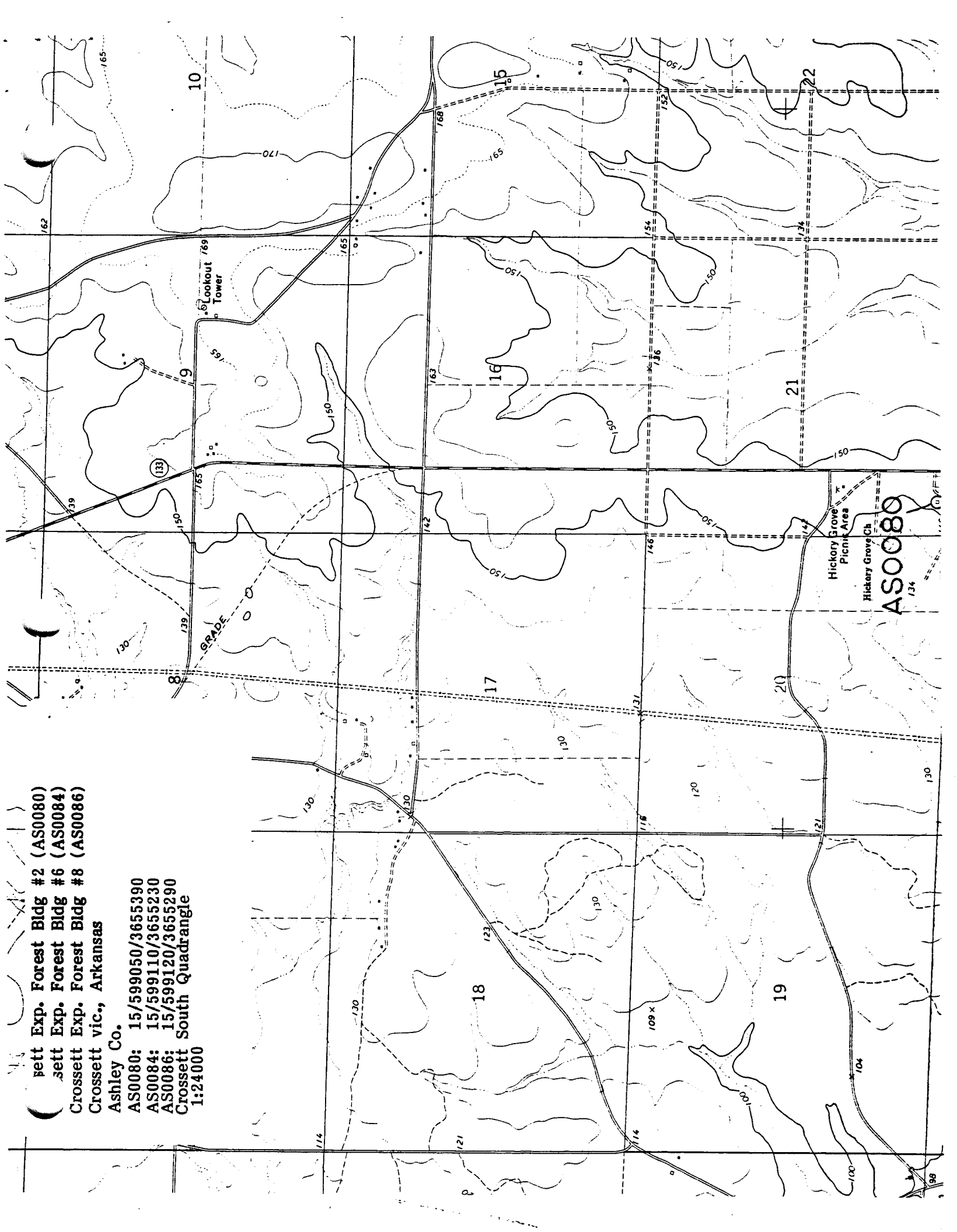

AS0080
 134

